

These foundations are specifically designed to be cement free. There must be no deviation from these details without written agreement from Straw Works Ltd.

Base Plate construction: 1no. 50x100mm C16 sawn untreated larch or douglas fir laid flat to outside, 1no. 50x150mm C16 sawn untreated softwood laid flat to inside with 50x100mm C16 softwood noggins.

32mmØ hole drilled through noggins to receive hazel stakes. Noggins to be at centres to suit overall straw bale sizes and bale plan layout.

Spaces between noggins to be filled with loose LECA or RFG to provide insulation and moisture control

20mm woodfibre board to outside face of box beam

Timber box ring beam of 2no. 300x45mm C24 to inside and outside edges with 300x45mm C16 noggins at 1200mm maximum centres; 18mm T&G SmartPly glued and ringshank nailed to top and bottom

30x35mm durable timber chamfered render stop

12x200mm durable timber (larch, oak, or similar) skirt to perimeter of building to protect exposed tyres

Marine ply cap to level up car tyre piers if necessary

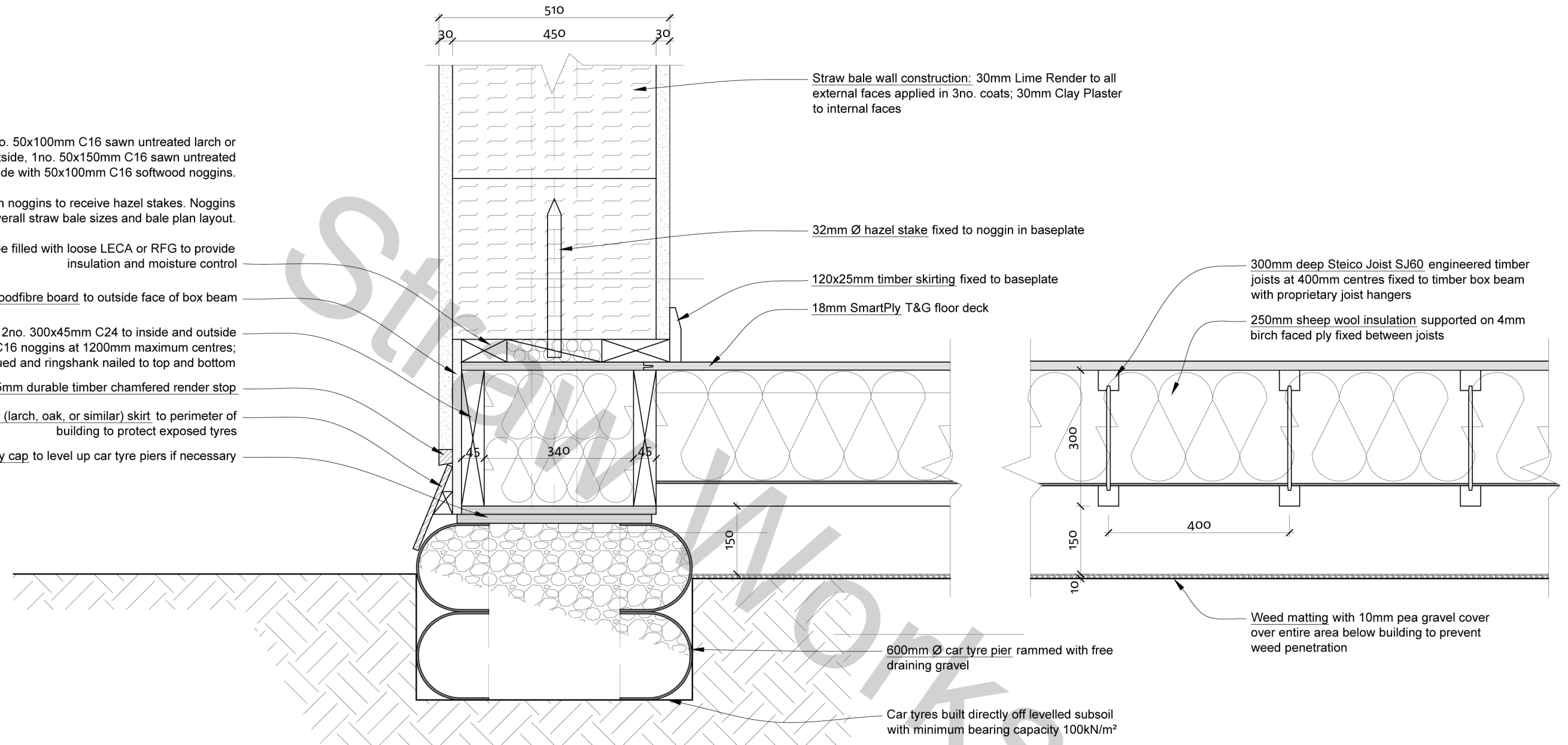

Section through tyres (parallel to joists)

Section through joists

Rising Damp & self draining foundations: car tyres and gravel are non-porous materials that do not allow moisture to wick upwards from the ground. The use of non porous materials means that there is no need for a damp proof course.